

Integrity Traditional Glider Sash Peg Replacement Field Applied Instructions

ABSTRACT: The following field service guide details the replacement of Integrity Traditional Glider sash pegs that are loose or missing. Please read instruction thoroughly before attempting any of the procedures.

NOTE: Numbers listed in parentheses () are metric equivalents in millimeters rounded to the nearest whole number.



WARNING

Practice safety! Wear safety glasses or goggles and appropriate hearing protection when assembling multiple Integrity window and door products.

Parts Included in Sash Peg Repair Kit

<u>Description</u>	<u>Part number</u>
Sash peg (beige)	156011
Threaded well nut	10830008
#8- 32 x 1" Phillips flathead machine screws	11800647

You Will Need to Supply

Safety glasses Hearing protection
#2 Phillips screwdriver
Screw gun/drill with 5/16" (8) drill bit

Open and Remove Operator Sash

1. Unlock the sash lock(s) and slide the operator sash open. Depress and hold down both tilt latches at the top of each stile. See figure 1.



Figure 1

2. With the latches depressed, tilt the sash towards the interior of the building until it clears the frame and jambs. Lift the sash off of the sill track. See figure 2.



Figure 2

Inspection and Removal of Pegs

1. Place operator sash on a flat, level surface. Be sure to protect both the exterior and interior surfaces from damage.
2. Inspect the area surrounding the sash peg(s), if present, for damage. If the sash Ultrex is cracked or broken, it will require a new sash. Please contact your local Integrity representative for replacement.
3. If no damage is visible, remove the sash peg(s) with a #2 Phillips screwdriver. Discard sash peg and screw.

Prep Sash for New Peg

1. Using the existing hole as a guide, drill a 5/16" (8) hole to a depth of no more than 7/8" (22) to avoid damaging the sash or glass. It may be necessary to use a drill bit stop collar. See figure 3.

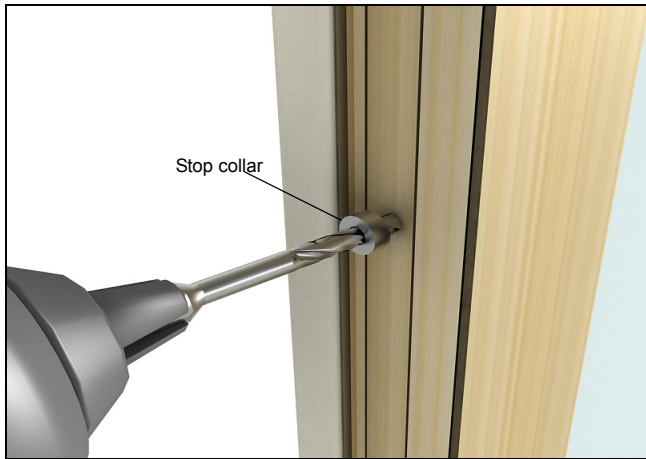

Figure 3

2. Insert machine screw through sash peg and partially thread it into the well nut. Be sure the well nut lip is adjacent to the sash peg. See figure 4.

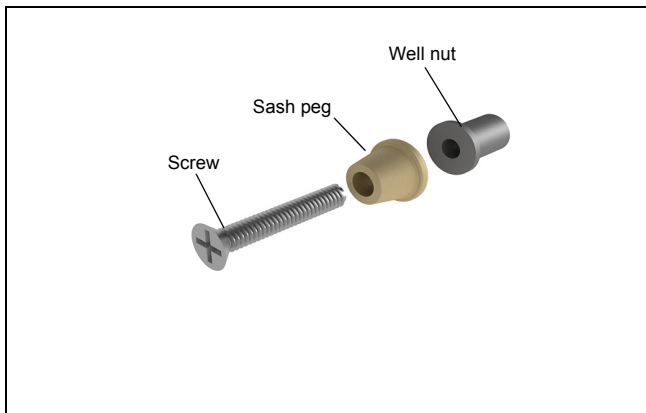

Figure 4

Installing New Sash Peg

1. Insert well nut/peg assembly, rubber end first into pre-drilled hole.
2. While pressing the sash peg against the sash Ultrex, use a #2 Phillips head screwdriver to tighten the screw until it is hand tight. See figure 5.



Figure 5

Reinstall Sash

1. Begin by placing the bottom of the sash on the sill track, depress and hold down the tilt latches and tilt the sash towards the frame. See figure 6.



Figure 6

2. Once the sash is vertical within the frame, release the tilt latches and check the operation of the sash.