

ALL ULTREX® SERIES ROUND TOPS

Mas. Opg. (mm) 2' - 6" (762)
Rgh. Opg. (mm) 2' - 6" (762)
Frame Size (mm) 2' - 5 1/2" (749)
Glass Size (mm) 27 3/32" (690)

1' - 3" (381)
1' - 3 1/4" (387)
1' - 2 3/4" (451)
12 1/2" (318)



IFRT 2613

Mas. Opg. (mm) 2' - 8" (914)
Rgh. Opg. (mm) 2' - 8" (914)
Frame Size (mm) 2' - 7 1/2" (902)
Glass Size (mm) 29 5/32" (741)

1' - 4" (406)
1' - 4 1/4" (413)
1' - 3 3/4" (400)
13 1/2" (343)



IFRT 2814

Mas. Opg. (mm) 3' - 0" (914)
Rgh. Opg. (mm) 3' - 0" (914)
Frame Size (mm) 2' - 11 1/2" (902)
Glass Size (mm) 33 3/16" (995)

1' - 6" (457)
1' - 6 1/4" (464)
1' - 5 3/4" (451)
15 1/2" (394)



IFRT 3016

Mas. Opg. (mm) 3' - 6" (1067)
Rgh. Opg. (mm) 3' - 6" (1067)
Frame Size (mm) 3' - 5 1/2" (1054)
Glass Size (mm) 39 3/16" (995)

1' - 9" (533)
1' - 9 1/4" (540)
1' - 8 3/4" (527)
18 1/2" (470)



IFRT 3619

Mas. Opg. (mm) 4' - 0" (1219)
Rgh. Opg. (mm) 4' - 0" (1219)
Frame Size (mm) 3' - 11 1/2" (1207)
Glass Size (mm) 45 3/16" (1148)

2' - 0" (610)
2' - 0 1/4" (616)
1' - 11 1/4" (603)
21 1/2" (546)

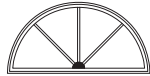

IFRT 4020

Mas. Opg. (mm) 5' - 0" (1524)
Rgh. Opg. (mm) 5' - 0" (1524)
Frame Size (mm) 4' - 11 1/2" (1511)
Glass Size (mm) 57 7/32" (1458)

2' - 6" (645)
2' - 6 1/4" (768)
2' - 5 3/4" (756)
27 1/2" (699)

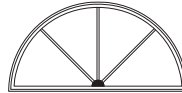

IFRT 5026

Mas. Opg. (mm) 5' - 4" (1626)
Rgh. Opg. (mm) 5' - 4" (1626)
Frame Size (mm) 5' - 3 1/2" (1600)
Glass Size (mm) 61 7/32" (1555)

2' - 8" (813)
2' - 8 1/4" (819)
2' - 7 3/4" (806)
29 1/2" (749)

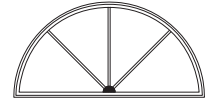

IFRT 5428

Mas. Opg. (mm) 6' - 0" (1829)
Rgh. Opg. (mm) 6' - 0" (1829)
Frame Size (mm) 5' - 11 1/2" (1816)
Glass Size (mm) 69 7/32" (1758)

3' - 0" (914)
3' - 0 1/4" (921)
2' - 11 3/4" (908)
33 1/2" (851)

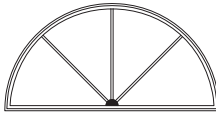

IFRT 6030

Mas. Opg. (mm) 7' - 0" (2134)
Rgh. Opg. (mm) 7' - 0" (2134)
Frame Size (mm) 6' - 11 1/2" (2121)
Glass Size (mm) 81 7/32" (2063)

3' - 6" (1067)
3' - 6 1/4" (1073)
3' - 5 3/4" (1060)
39 1/2" (1003)

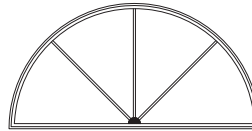

IFRT 7036

Mas. Opg. (mm) 8' - 0" (2438)
Rgh. Opg. (mm) 8' - 0" (2438)
Frame Size (mm) 7' - 11 1/2" (2426)
Glass Size (mm) 93 7/32" (2368)

4' - 0" (1219)
4' - 0 1/4" (1226)
3' - 11 3/4" (1213)
45 1/2" (1156)

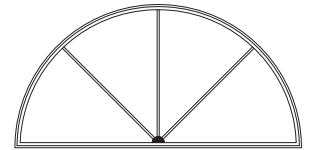

IFRT 8040

Multiple Assemblies

Mas. Opg. (mm) 3' - 0" (914)
Rgh. Opg. (mm) 3' - 0" (914)
Frame Size (mm) 2' - 11 1/2" (902)

6' - 6" (1981)
6' - 6 1/4" (1975)
6' - 5 3/4" (1986)

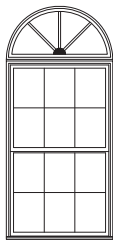

IFRT 3016
Over IFDH 3050

Mas. Opg. (mm) 5' - 0" (1524)
Rgh. Opg. (mm) 5' - 0" (1524)
Frame Size (mm) 4' - 11 1/2" (1511)

7' - 0" (2134)
7' - 0 1/4" (2140)
6' - 11 3/4" (2127)

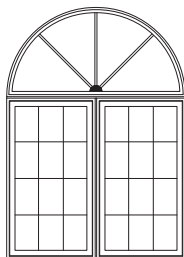

IFRT 5026
Over IFCA 2646

Construction Details

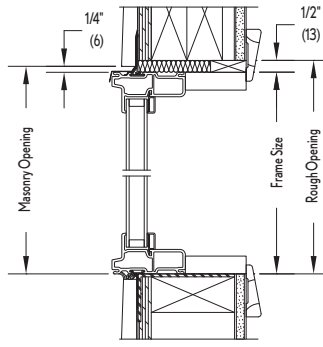

Head Jamb & Sill

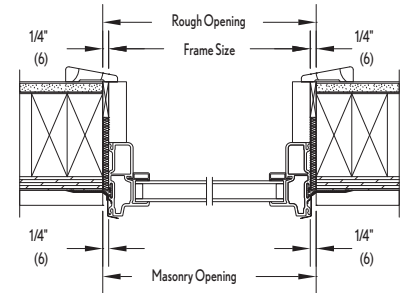

Jambs

GBG only available in standard Round Top pattern shown.
Details and Elevations not to scale.

MULTIPLE ASSEMBLIES

Multiple assemblies can be factory mulled up to 2 units wide by 2 units high.
MAXIMUM ROUGH OPENING: not to exceed 96" x 96" or up to 2 units wide by 2 units high. Both horizontal and vertical field mull kits are available. Structural mullion reinforcement is required for some assemblies.

Please consult your local Integrity from Marvin representative for more information.